



ZROADZ
OFF ROAD PRODUCTS

IMPORTANT – READ ALL INSTRUCTIONS CAREFULLY AND COMPLETELY *BEFORE* ATTEMPTING INSTALLATION.

CORRECT INSTALLATION OF WIRING IS THE RESPONSIBILITY OF THE CUSTOMER AND WILL NOT BE COVERED IN THESE INSTRUCTIONS. WE ARE NOT LIABLE FOR ANY DAMAGE WHICH OCCURS DUE TO IMPROPER INSTALLATION. WE STRONGLY RECOMMEND INSTALLATION BE PERFORMED BY A PROFESSIONAL.

What's Included:

ITEM	DESCRIPTION	QTY
1	Main Bracket	1
2	Top Bracket	1
3	Manifold Replacement Bracket	1
4	Heat Shield	1
5	1/2" Rubber Hose	2
6	JIC-4 Stainless Steel Braided Hose	1
7	M6 x 25mm Bolt	1
8	M6 x 14mm Bolt	2
9	M6 Washer	3
10	M6 Flange Nut	2
11	Aluminum Spacer	2
12	1/4" NPT Brass Bulkhead Fitting	1
13	JIC-4 to 1/4" Male NPT Fitting	2
14	1/2" Hose Barb to 1/4" Male NPT Fitting	2
15	1/2" Hose Barb to 1/4" Female NPT Fitting	2

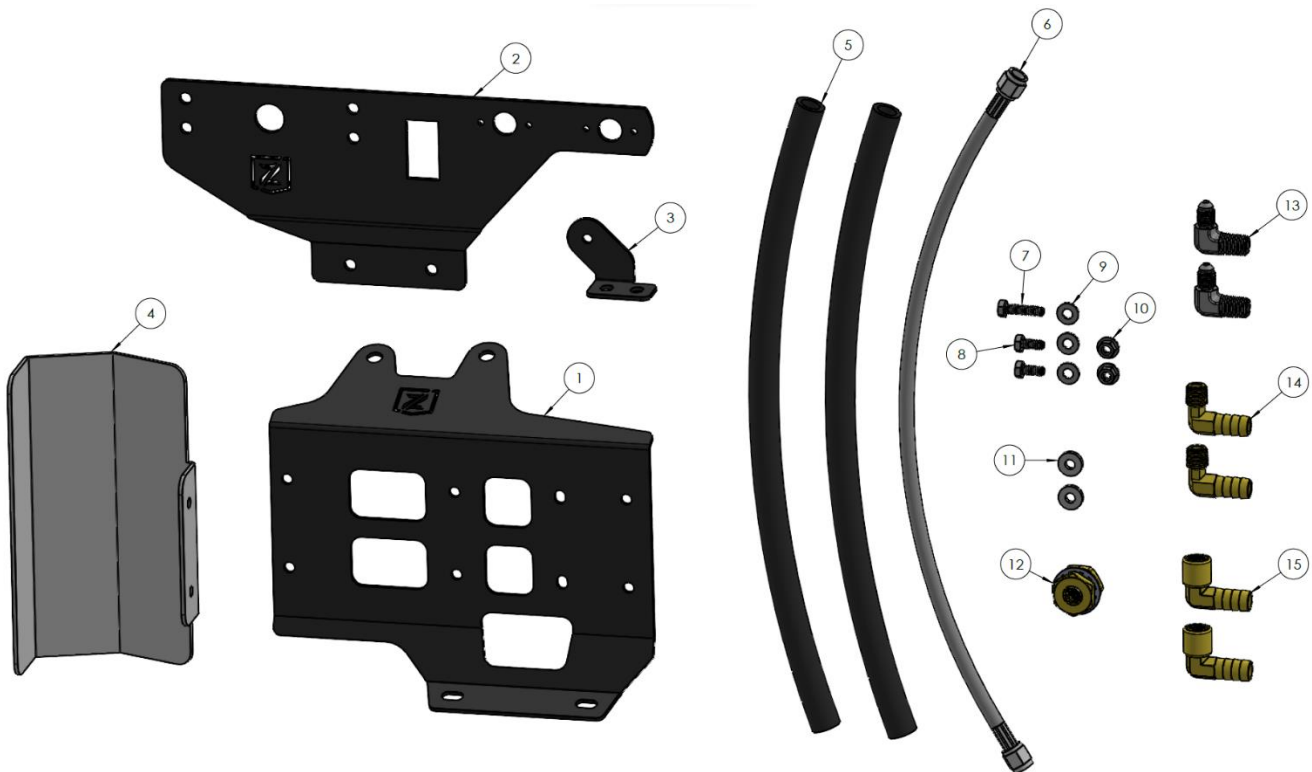



ZROADZ
OFF ROAD PRODUCTS

Tools Needed:

- 10mm Socket or Wrench
- 13mm Socket or Wrench
- 10mm Open-Ended Wrench (optional)
- 4mm Allen Wrench (for Single Compressor only)
- 9/16" Open-Ended Wrench

NOTE: Some of the plastic fender flare clips may break when removing the fender flare. Plan ahead by obtaining spare clips in advance (Mopar part number 68526185AA).

Step 1 – Remove Fender Flare

1. Remove the (5) fender liner bolts [**10mm**] and (1) push pin clip.
2. Starting at one end, firmly pull the fender flare away from the vehicle body to remove it.
3. Disconnect the wire harness connector by pulling on the red tab, then pulling both sides apart.

Step 2 – Relocate Wire Harness

1. Locate the wire harness plug mounting bracket. Remove the (2) nuts [**10mm**] from the wire harness plug mounting bracket. **Save the (2) nuts.**

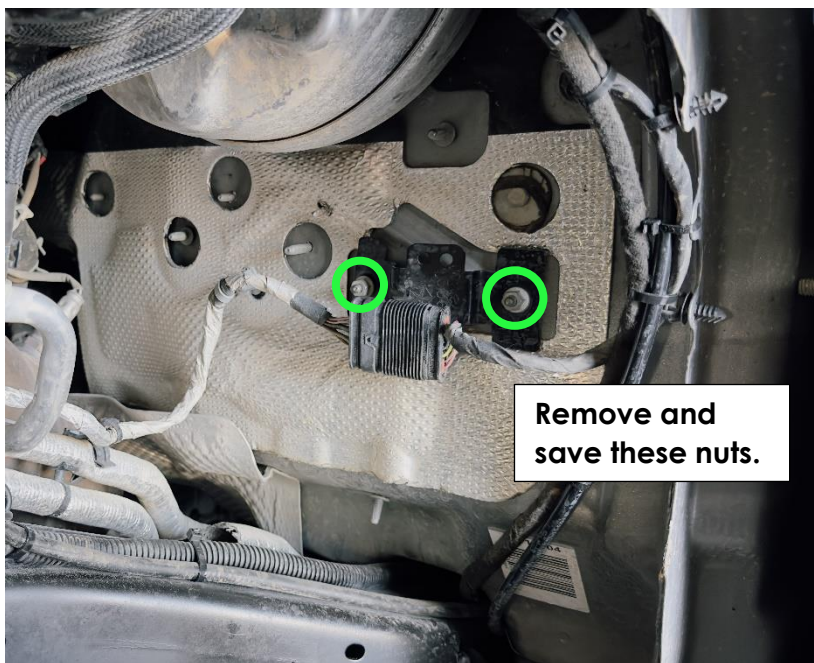



ZROADZ
OFF ROAD PRODUCTS

2. Use a pair of pliers to pry the wire harness plug from the bracket. You may discard the bracket, as it is no longer needed.



3. The wire harness is zip-tied to a stud-mounted plastic retaining clip. Cut this zip-tie to release the wire harness from the clip.
4. Remove the retaining clip from the factory-installed stud and move it to the stud directly below the brake booster.
5. Using a new zip-tie, secure the wire harness to the retaining clip in the new location.





ZROADZ
OFF ROAD PRODUCTS

Step 3 – Mount Compressor and Heat Shield to Main Bracket

(A) For Twin Compressor:

1. Lay the compressor upside down and align the holes of the Main Bracket and Heat Shield with the bolt holes of the compressor. Ensure the compressor's cable connectors pass through the opening in the Main Bracket, as shown.
2. Install the bolts and washers which were supplied with your ARB compressor.

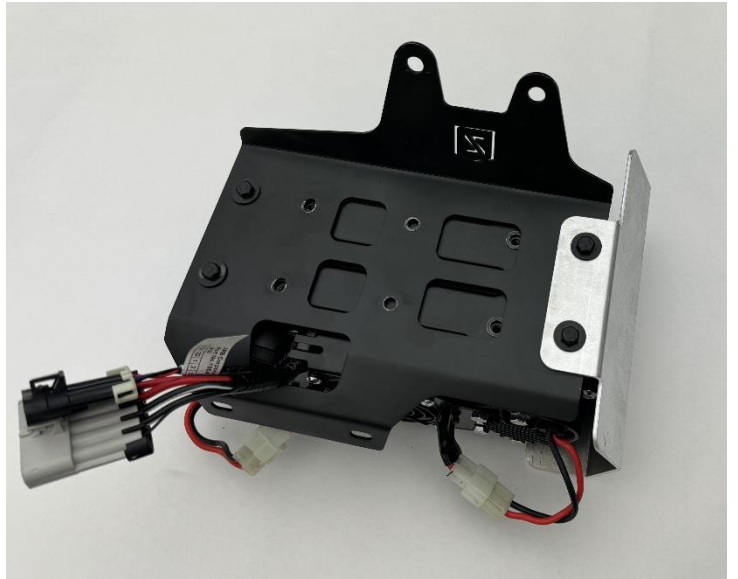
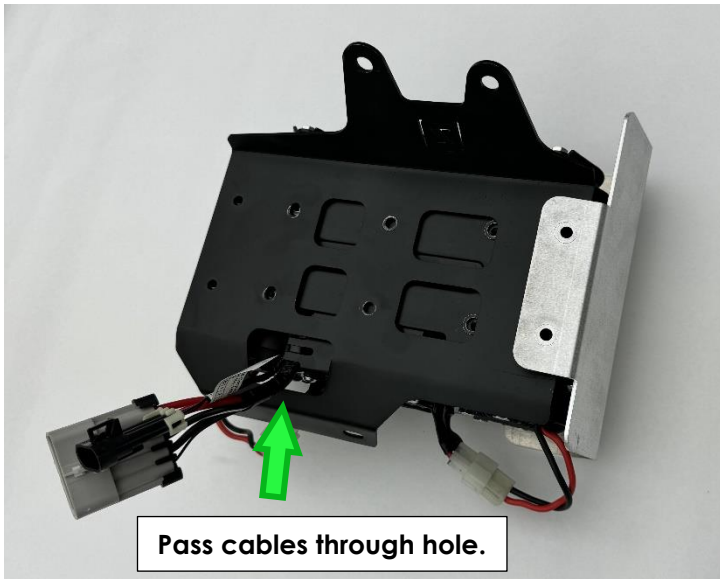

3. Install the (2) 1/4" NPT Male hose barb fittings into the compressor air intake ports, using Teflon tape or thread sealant, and orient fittings as shown.
4. Install (1) 1/4" NPT Male to JIC-4 elbow fitting into the compressor output port, using Teflon tape or thread sealant, and orient fitting as shown.

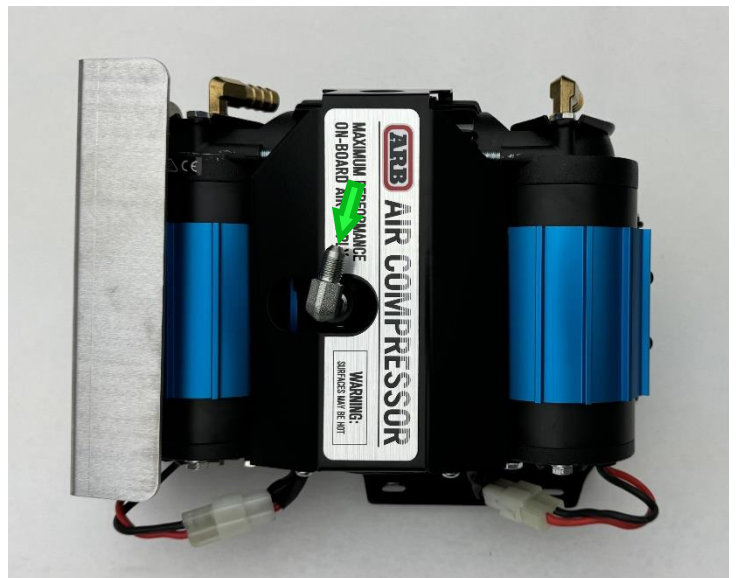
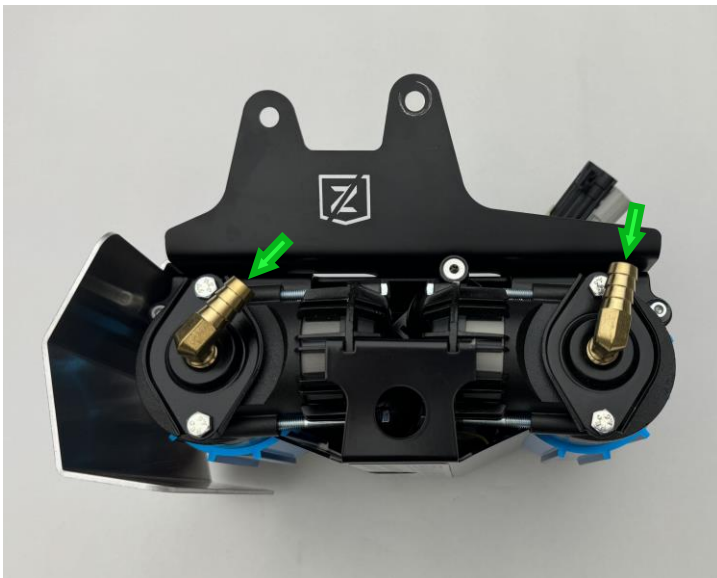



ZROADZ
OFF ROAD PRODUCTS

Note: NPT fittings must not be overtightened. If a fitting does not point in the correct direction when tightened (as shown), remove the fitting, apply more Teflon tape, and reinstall. Repeat, if necessary, until the correct orientation is achieved.

(B) For Single Compressor:

1. Install the compressor onto the Main Bracket using the bolts, washers, and nuts included with your compressor. Use the (4) holes in the center of the Main Bracket.
2. Once mounted, use a **4mm** Allen wrench to loosen the (2) screws which secure the compressor motor in its heat sink, and rotate the compressor so it sits at a 90-degree angle, as shown, then re-tighten the Allen screws.

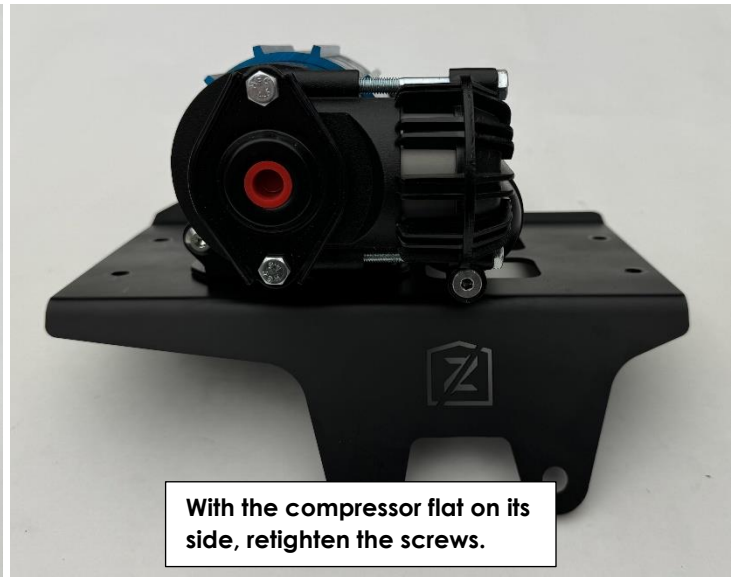

3. Install (1) 1/4" NPT Male hose barb fitting into the compressor intake port, and orient fitting as shown.
4. Install (1) 1/4" NPT Male to JIC-4 elbow fitting into the compressor output port, using Teflon tape or thread sealant, and orient fitting as shown.

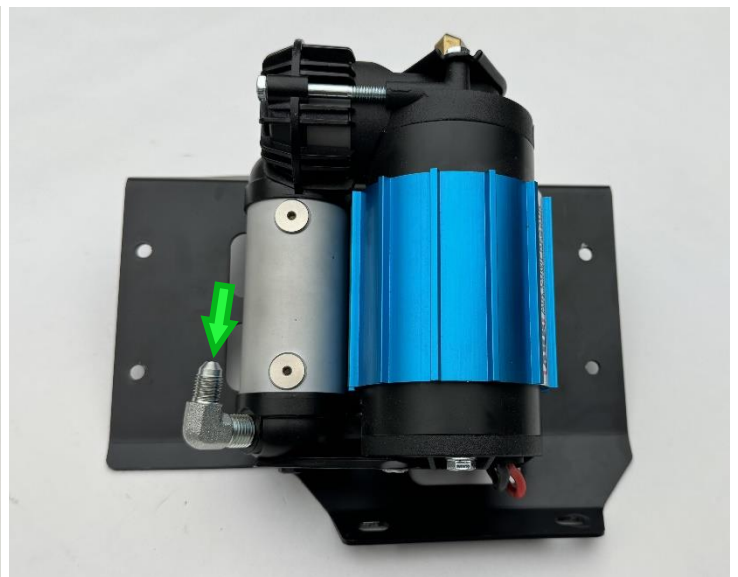
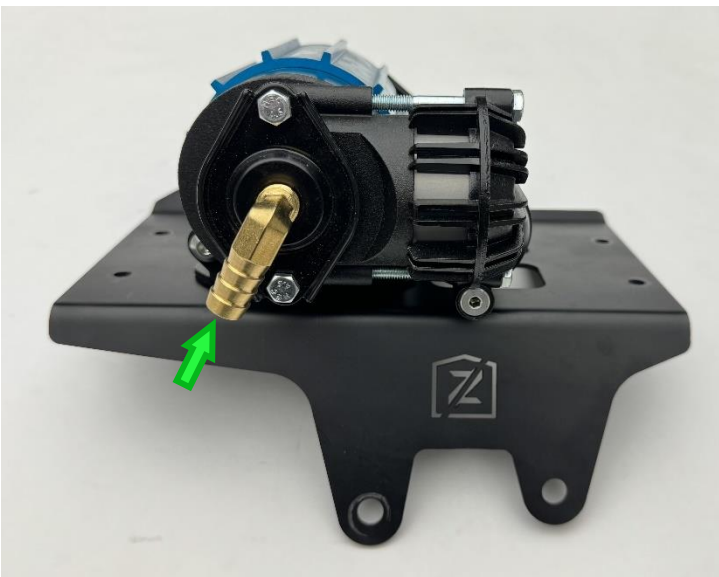



ZROADZ
OFF ROAD PRODUCTS

Note: NPT fittings must not be overtightened. If a fitting does not point in the correct direction when tightened (as shown), remove the fitting, apply more Teflon tape, and reinstall. Repeat, if necessary, until the correct orientation is achieved.

5. Install the Heat Shield as shown, using (2) M6 x 14mm bolts, Washers, and M6 Flange Nuts.



Step 4 – Install Main Bracket in Vehicle

1. Remove the lower Master Cylinder Nut [13mm]. **Save the nut.**

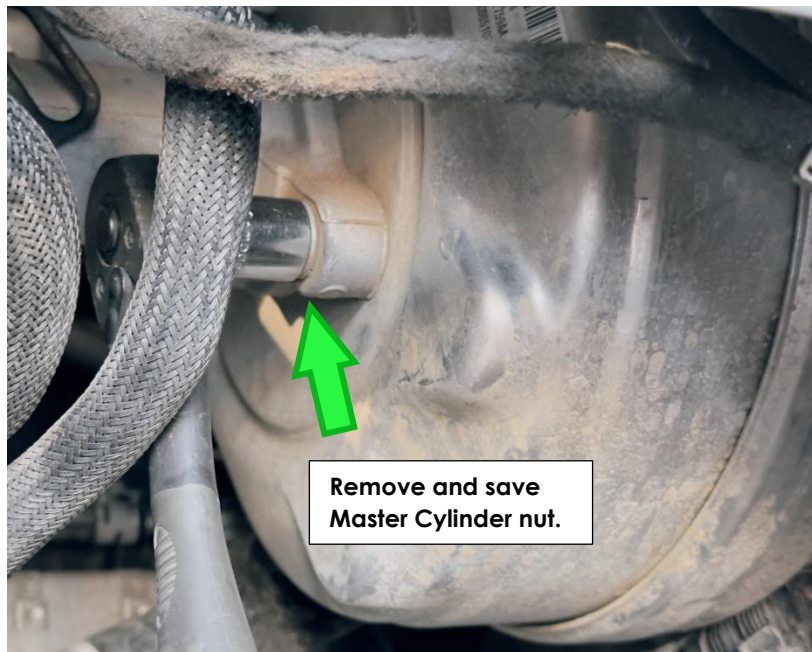



ZROADZ
OFF ROAD PRODUCTS

2. Place the (2) Aluminum Spacers onto the firewall studs, as shown.

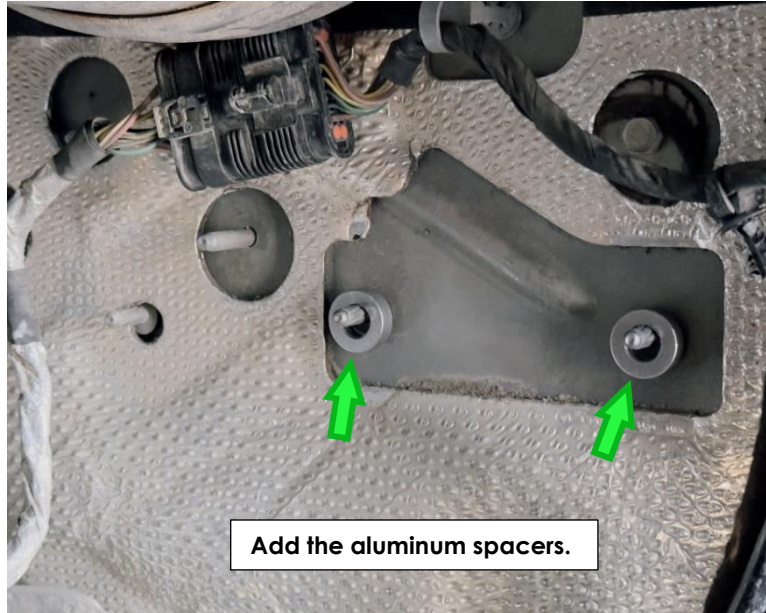

3. Install the Main Bracket and compressor assembly onto the Master Cylinder stud and firewall studs, as shown. *Note: the bracket hole used for the Master Cylinder stud will vary depending on vehicle model and may not reflect what is shown.*



4. Reinstall the lower Master Cylinder Nut [**13mm**] and the (2) firewall nuts [**10mm**] as shown.
5. Reinstall the (2) nuts [**10mm**] saved earlier during "Step 2 – Relocate Wire Harness" onto the firewall studs.



ZROADZ
OFF ROAD PRODUCTS

IMPORTANT: If Installing ARB Manifold, the manifold must be disassembled and reassembled with our included replacement bracket. The purpose of this replacement bracket is to allow the quick-disconnect air fitting to sit horizontally, which is necessary for hood clearance.

Manifold Bracket Replacement Instructions

1. With the mounting brackets pointing towards you, begin by unscrewing the right-side bolt [10mm] as shown. You will need (2) wrenches to prevent the left-side bolt from spinning whilst loosening the right-side bolt.



2. Once free, *carefully* remove the long shoulder bolt from the manifold assembly. **DO NOT LOSE THE O-RING.**

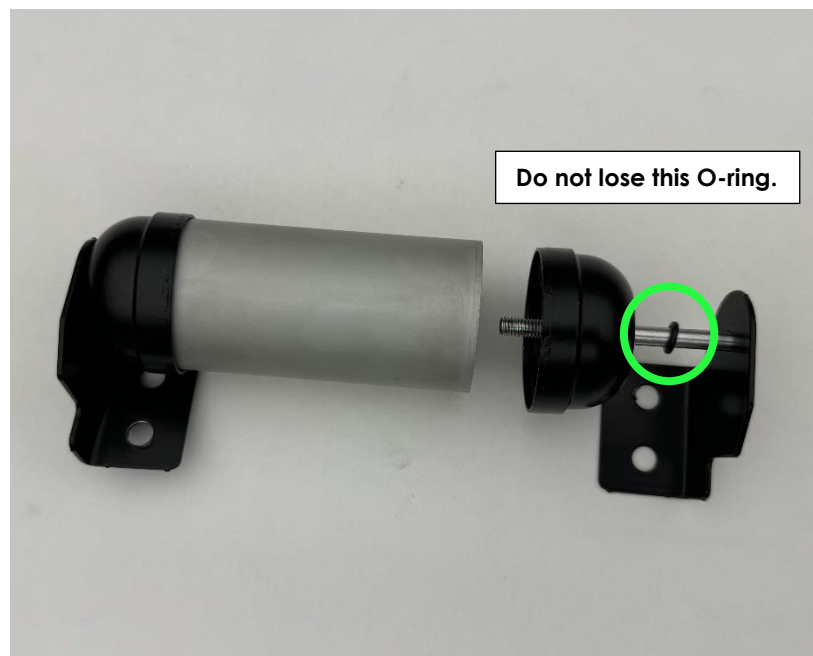



ZROADZ
OFF ROAD PRODUCTS

3. Reassemble the manifold with our replacement bracket. Don't forget the O-ring. Before fully tightening, align the black endcaps as shown, with the right-side endcap hole facing you, and the left-side endcap hole facing away from you.



Step 5 – Install Filters and Accessories onto Top Bracket

1. Install the ARB Compressor Intake Filters which came with your compressor onto the Top Bracket as shown, using the provided 1/4" NPT Female hose barb fittings.

Note: Avoid overtightening the NPT fittings to the air filters, as the plastic threads can strip easily.

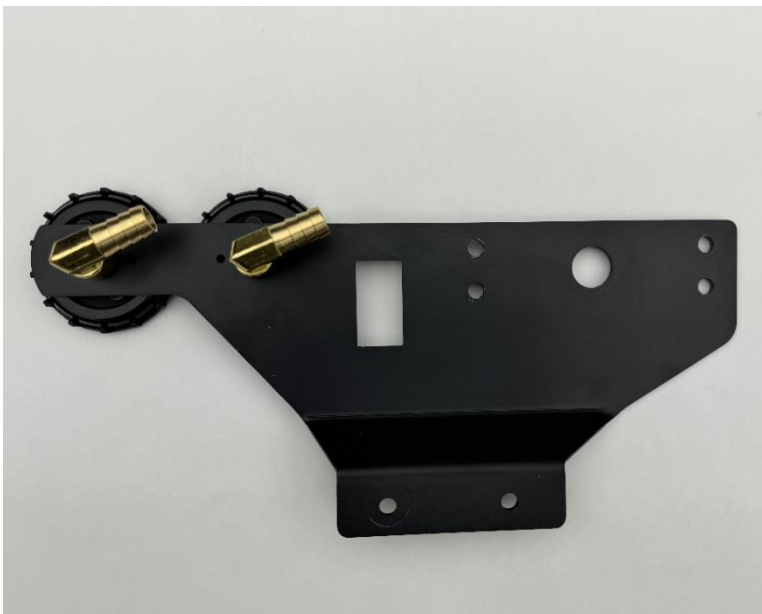



ZROADZ
OFF ROAD PRODUCTS

2. Install either **(A)** Manifold, or **(B)** Brass Bulkhead Fitting.
(A) If installing the ARB Manifold, proceed to mount the manifold (with replacement bracket) to the Top Bracket using the hardware which came with the manifold kit, as shown.
(B) If not installing ARB manifold, proceed to install the provided Brass Bulkhead Fitting onto the Top Bracket, as shown.
3. Install (1) 1/4" NPT Male to JIC-4 elbow fitting into either (A) ARB Manifold, or, (B) Brass Bulkhead Fitting. Use Teflon tape or thread sealant, and orient fitting as shown.

Option A: Install Manifold.



Install JIC-4 fitting.

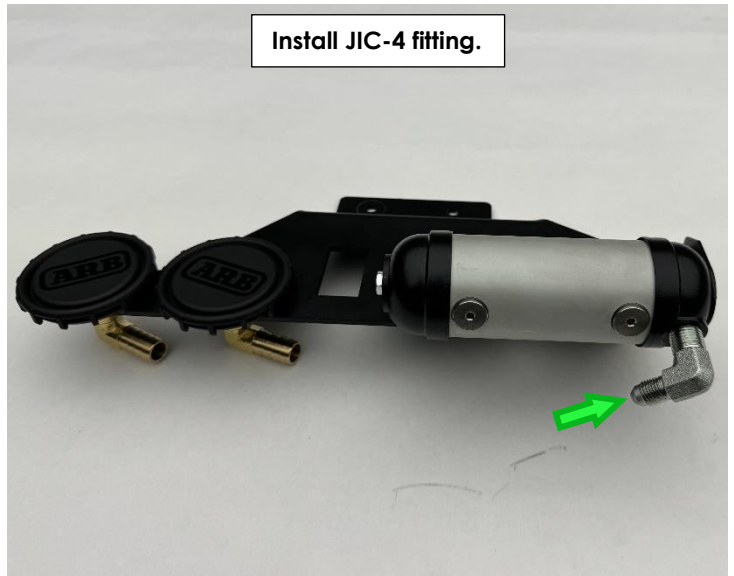

Option B: Install Bulkhead.

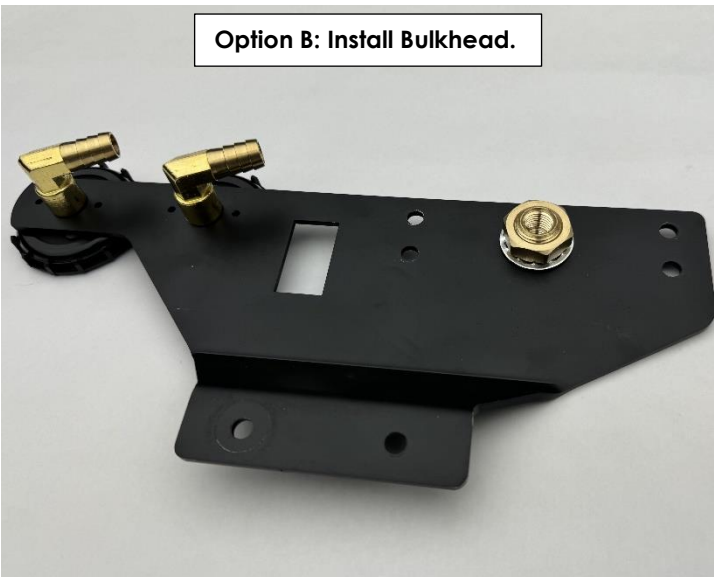

Install JIC-4 fitting.

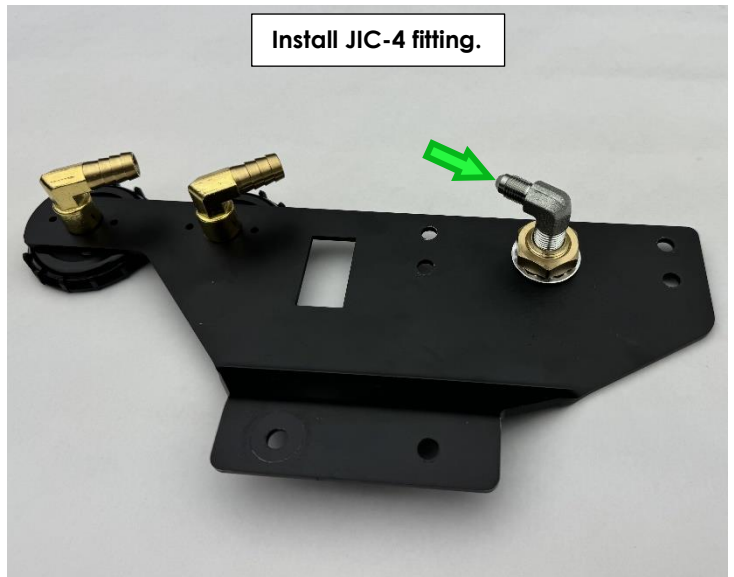



ZROADZ
OFF ROAD PRODUCTS

Step 6 – Install Hoses to Compressor

1. Install the ½" Rubber Hoses onto the Hose Barb fittings previously installed on the compressor; (2) hoses for the ARB Twin compressor, or, (1) hose for the ARB Single compressor. *Hose clamps are not necessary for these low-pressure connections.*
2. Install the JIC-4 Braided Stainless Steel Hose onto the JIC-4 fitting previously installed on the compressor. JIC fittings are flared fittings and do not require any Teflon tape or thread sealant.

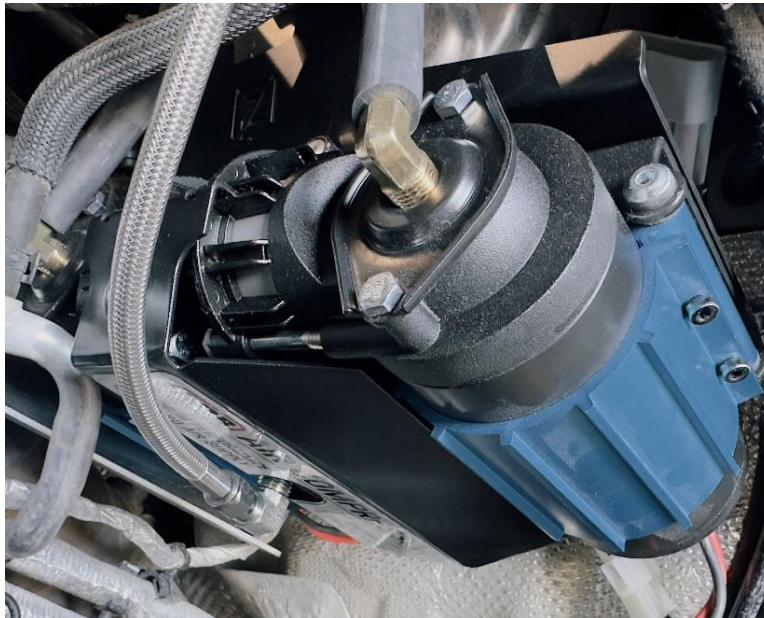

3. Route the hoses up through the engine bay, as shown.





ZROADZ
OFF ROAD PRODUCTS

Step 7 – Install Top Bracket Assembly to Vehicle

Note: Top Bracket is shown with on/off toggle switch installed for reference only. You may choose to install the switch later, when installing wiring.

1. Remove the painted factory bolt [10mm]. **Save this bolt.**

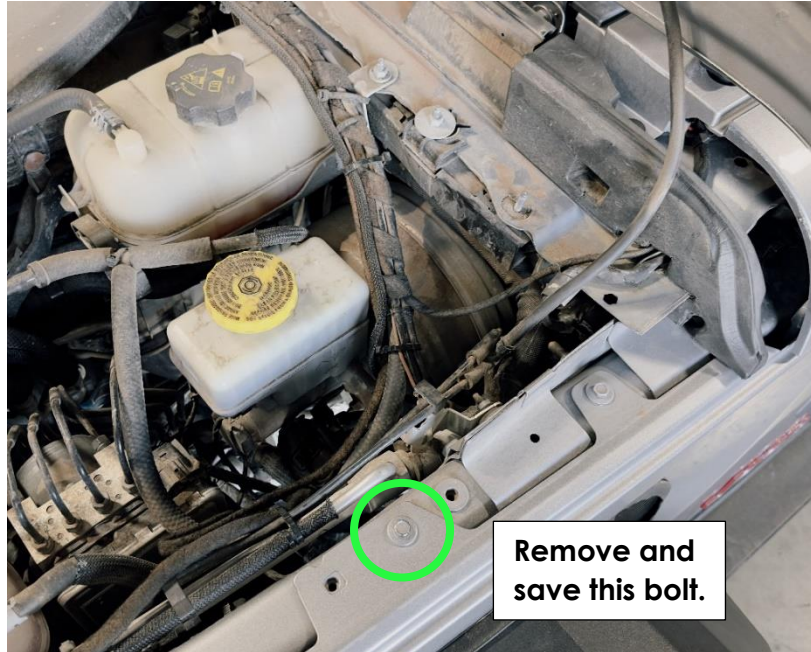

2. Install the rubber hoses onto the Hose Barb fittings, and the Braided Stainless Steel Hose onto the JIC-4 fitting on the Top Bracket Assembly.

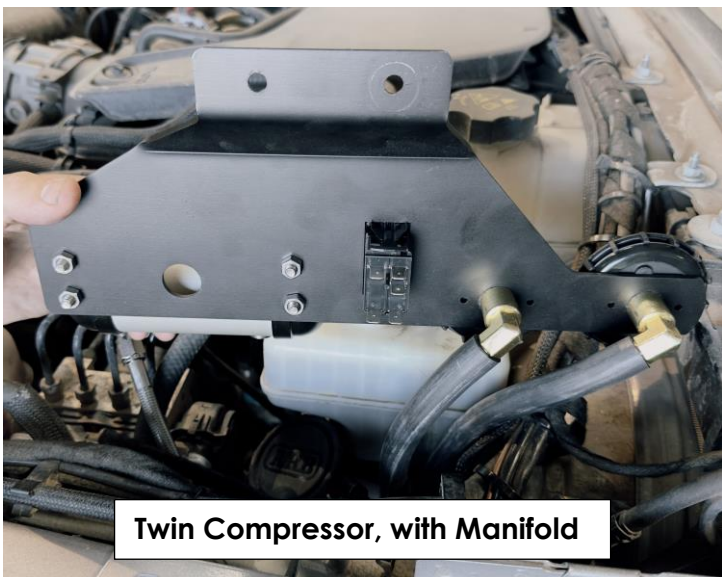



ZROADZ
OFF ROAD PRODUCTS

3. Mount the Top Bracket Assembly onto the fender panel, reusing the factory bolt, and using the provided M6x20mm bolt [10mm] and washer.

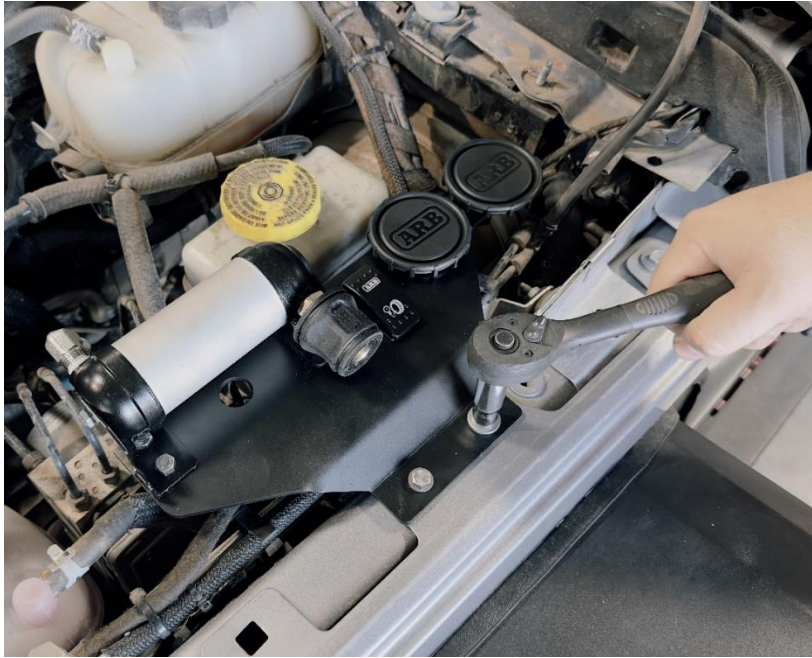

You have now completed mechanical installation of your compressor.

For electrical wiring, refer to the ARB Compressor Installation Guide which came with your compressor.